

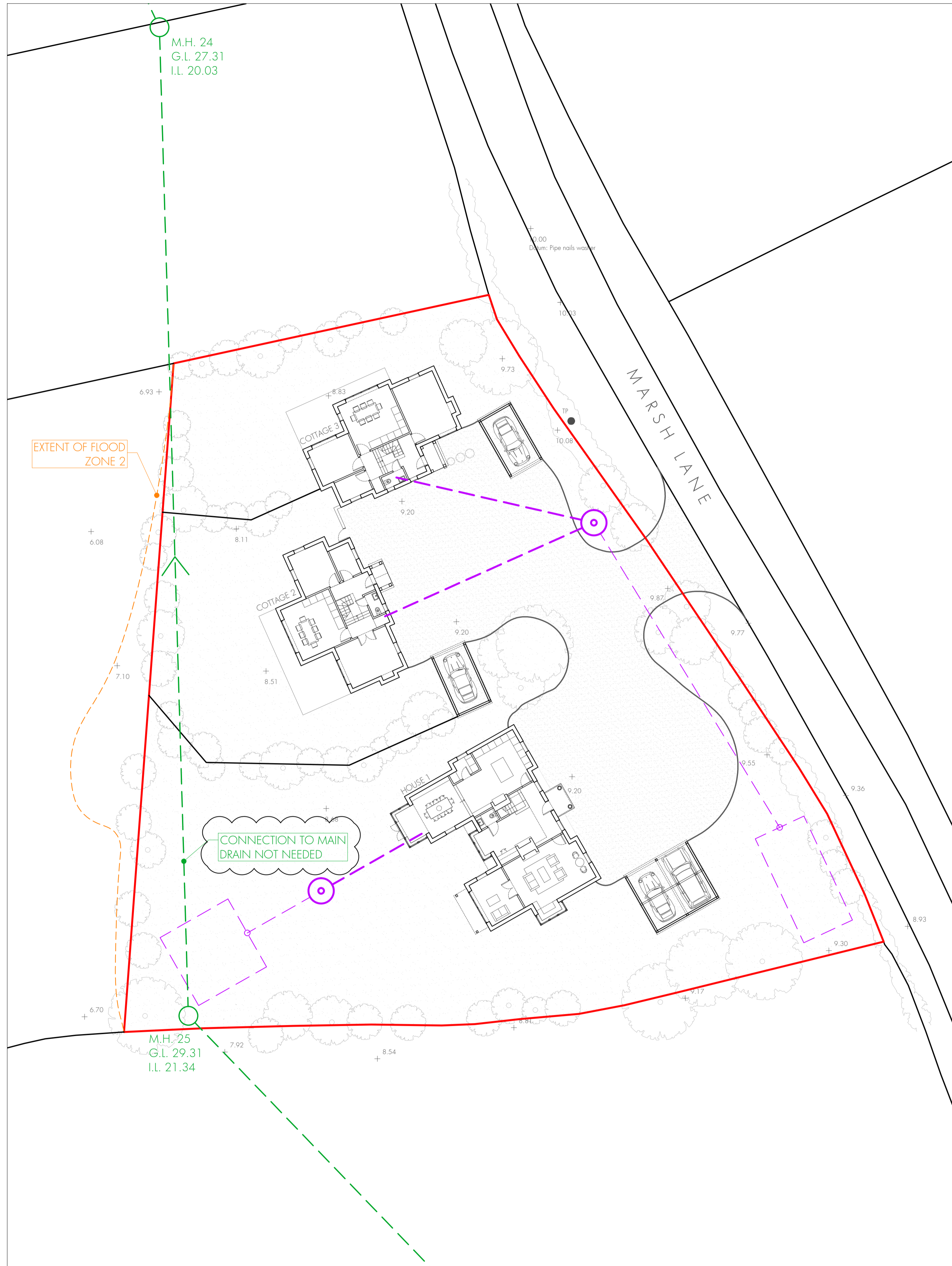

LOCATION PLAN - 1/1250



SITE PLAN - 1/200

NOTES:
 This drawing should not be scaled.
 The contractor is to verify all dimensions and conditions on site and report any discrepancies to the Architect immediately.
 This drawing is to be read in conjunction with all relevant documents and drawings.
 Copyright: Neil Tomlinson Architects 2017
 www.ntarc.co.uk

SCALE BAR 1:200

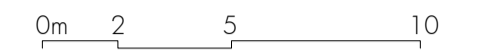

SCALE BAR 1:1250

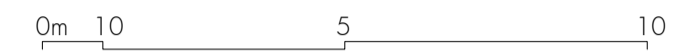

DRAINAGE KEY:

- DRAINAGE FOR PROPOSED DWELLINGS
- SEPTIC TANK
- INSPECTION CHAMBER
- DRAINAGE FIELD

SEPTIC TANK

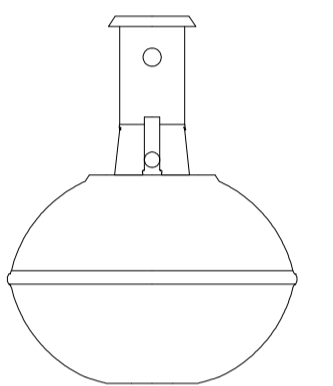

British Water Code of Practice - Flows and Loads:

- House 1:
 - 4 Bedrooms = 6 people = 2900L
 - Proposed Septic Tank = 3800L
- Cottage 2 + Cottage 3:
 - 3 + 3 Bedrooms = 10 people = 3500L
 - Proposed Septic Tank = 3800L

REGULATIONS & LEGISLATION:

Building Regulations 2010 - Drainage and waste disposal
 DEFRA General binding rules for small sewage discharges
 BS EN 12566-1 for septic tanks
 BS 6297:2007 for drainage fields
 British Water Codes of Practice

REV	DATE	DESCRIPTION	DRN	CHKD
A	03.11.2017	CONNECTION TO MAIN DRAIN NOT NEEDED SEPTIC TANK AND DRAINAGE FIELD ADDED	BSG	NT

KEY PLAN:

NEIL TOMLINSON Architects

TELEPHONE +44 (0)20 7089 5747
 FACSIMILE +44 (0)20 7089 5748
 EMAIL INFO@NTARC.CO.UK
 WWW.NTARC.CO.UK
 HORSESHOE WHARF, 6 CLUNK STREET, LONDON, SE1 9FD

DRAWING STATUS:
 FOR PLANNING

CLIENT:
 DAVID AND JULIA TOMLINSON
 PROJECT:
 Land South of Chapel View, Marsh Lane, Bolton Percy

DATE:
 November '17
 SCALE:
 AS INDICATED/B1
 DRAWN BY:
 BSG
 CHECKED BY:
 NT

DRAWING TITLE:
 PROPOSED
 LOCATION AND SITE PLANS

DRAWING NUMBER:
 TNH002-08-20-SP-001
 REVISION:
 A